

# HEMA

## Wood Chip Grapple Type FG50-90

The wood chip grapple is designed for a working pressure of 170-200 bar, making it applicable to almost all types of auto cranes.

The horizontal and well-protected cylinder provides an extra low construction height, high closing force and a quick opening time of the grapple.

The adjustable cylinder compensates for wear on the blades.

The HEMA grapple opens up so that the blades are vertical, enabling the grapple to grab all the way to the truck's sides.

As a special model, the grapple can be delivered either with closed or semi-closed shells, different designs of the side and bottom blades, such as jagged teeth, special teeth or welded blades.

The grapple is delivered with individual adjustment of bolt-mounted link for a rotator with a shaft.

All moving points are equipped with lubrication and replaceable bearings, which will make any potential reparation easy, fast and affordable.



**HEMA Wood Chip Grapple  
FG90-1250**



**HEMA Wood Chip Grapple  
FG90-3000**

**HEMA Wood Chip Grapple  
FG90-1250  
Special closed**

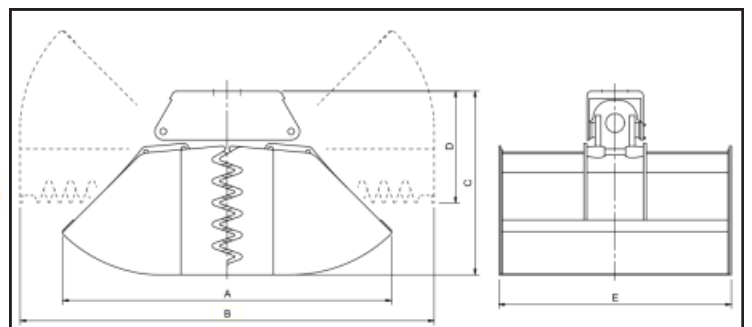

Product no.	TYPE	Bar	Contents	A mm	B mm	C mm	D mm	E mm	Weight kg
3015 5420	FG90-1000	200	1000 L	1740	2270	970	600	1200	500
3015 5425	FG90-1250	200	1250 L	1740	2270	970	600	1515	550
3040 5440	*FG90-2000-2	200	2000 L	1825	2505	1125	1010	2015	1000
3020 5450	*FG90-2250-2	200	2250 L	2050	2600	1160	685	2030	1200
3020 5460	*FG90-3000-2	200	3000 L	2280	2550	1150	1310	2530	1555

\* Over 1500 L = 2 hydraulic units.



**HEMA**  
K.S.M. Kragelund ApS.  
Bøgballevej 19, Kragelund, DK-8723 Løsning  
Tlf. + 45 75893711 - Fax. + 45 75893709  
Mail: hema@ksm-hema.dk / www.hema.world

Manufacturing and sales of  
HEMA Crane Equipment  
and Mudguards

