

HEMA

Waste Grapple X- series

This waste grapple is designed for a working pressure of 200-320 bar, making it applicable to almost all types of excavators.

The HEMA waste grapple is mounted on a service and maintenance-friendly hydraulic top, with lubricating bushings in all the moving points and a cylinder that is adjustable in stroke length.

Aside from the standard model, the waste grapple is delivered with individual teeth adjustment in terms of design and quantity, depending on what materials and tasks the grapple is going to be used for.

The standard models come with fixed blades but can be delivered with bolt-on blades or completely without.

The X-grapples opens, so the arms are vertical, making it easier to get into the often difficult mass, such as garbage, garden waste and branches.

For the assembly of machine fitting there are bolt holes in the top plate and if needed a welding plate can be supplied, which can be welded directly onto the fasteners.

The X-waste grapple can be delivered with different dimensions.

Please inquire our sales department for further information.



**HEMA Waste Grapple
AGX60/100-800**

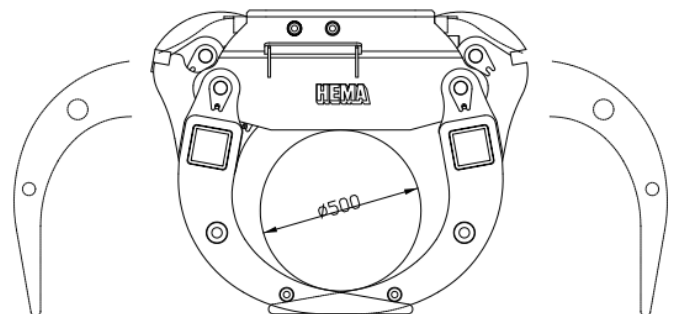

**HEMA Waste Grapple
AGX-T 60/100-1400**

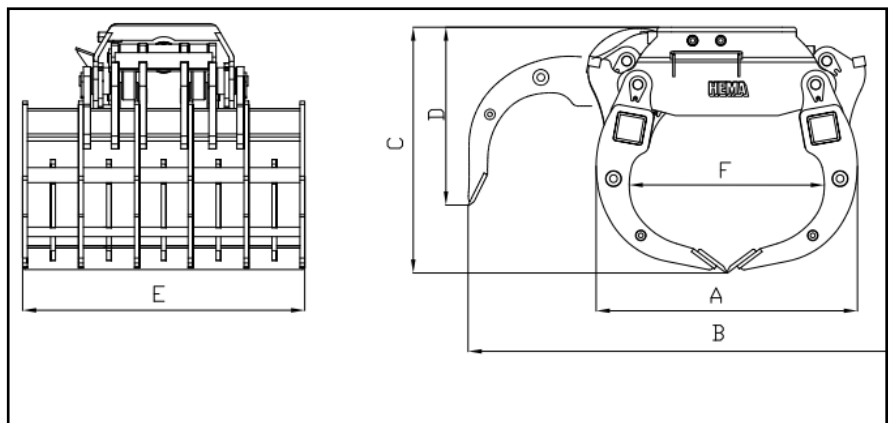

| Product nr. | TYPE | Bar | Ind- hold | A mm | B mm | C mm | D mm | E mm | F mm | Weight kg |
|-------------|-------------------|-----|--------------|---------|---------|---------|---------|-----------|---------|--------------|
| 30255820 | AGX 60/100-800 | 350 | 550 L | 1090 | 2165 | 1030 | 745 | 840 | 815 | 825 |
| 30255830 | AGX 60/100-1200 | 350 | 650 L | 1090 | 2165 | 1030 | 745 | 1180 | 815 | 900 |
| | AGX 60/100-1400 T | 350 | 750 L | 1010 | 1860 | 1045 | 980 | 1180/1440 | 675 | 950 |