

HEMA MINI GRAPPLE

Model Idrobenne

The mini grapples are designed for a working pressure of 170-250 bar, making it applicable on almost all types of auto cranes.

The mini grapple's size and geometry makes it perfect for tasks such as deepening of wells and excavation for repair work in connection with pipelines and the like.

With its small opening measurements, the mini grapple can be used for emptying smaller containers and its low weight allows it to be mounted on cranes from 3 Tm.

The mini-grapple is prepared for mounting by suspension or rotator with mounting flanges 140x140xØ17, making it easy to mount suspension and rotators with standard adapters.

The mini-grapple is a supplement to HEMA's standard program, which is mainly aimed at the heavier sector within the transport and contractor industry, to meet the great demand for smaller and lighter tools for smaller cranes.

HEMA can deliver additional models than those shown. Request a brochure for the other models by contacting HEMA Crane Equipment.

The grapple is delivered with individual adjustment of bolt-mounted suspension for a rotator with a shaft.



Excavator Grapple BMV- 2/500



Orange Peel Grapple PFO-5/100

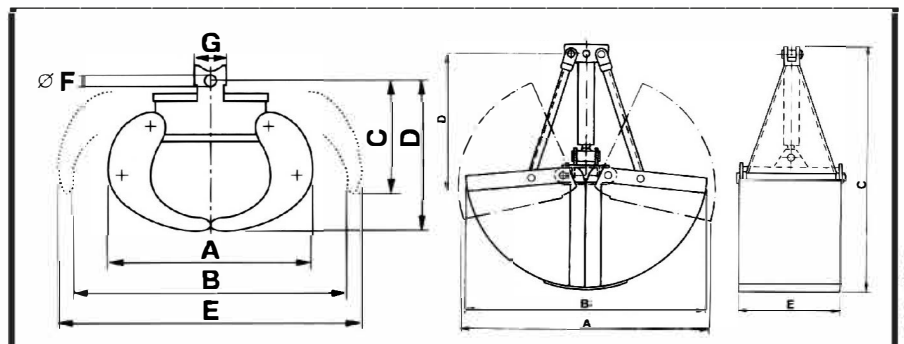

Product nr.	TYPE	Bar	Contents	A mm	B mm	C mm	D mm	E mm	Weight kg
3019 1048	BMV -2/250	250	250 L	1340	1230	1170	940	520	260
	BMV -2/350	250	350 L	1340	1230	1170	940	670	280
3019 1050	BMV -2/500	250	500 L	1340	1230	1170	940	800	300
3009 1025	PFO - 5/100	200	100 L	750	1070	580	750	1200	140