

HEMA

Combi Grapple Type CG 50-90

The Combi grapple is designed for a working pressure of 170 – 200 bar, making it applicable to almost all types of truck mounted cranes.

The horizontal and well-protected cylinder provides an extra low design height, large closing force and quick time opening of the grapple. The cylinder is adjustable as compensation for wear on the blades.

The Combi Grapple is a universal tool with many different applications. It is installed with side plates which makes the grapple function as a standard grapple. Without the side plates the grapple is suitable for handling of cobblestone, branches, garbage and other products.

The HEMA Combi Grapple is mounted on a service and maintenance-friendly hydraulic top, with the possibility to easily change the tool.

When the grapple opens up, the blades are vertical, thus allowing the grapple to grab all the way to the truck's sides.

The grapples is delivered with individual adjustment of the bolt mounted suspension for rotators with shafts. All moving points are supplied with effective lubrication as well as interchangeable bearings, making any potential repair, easy, fast and affordable.

Extra Equipment

With rubber clamps the grapple can also handle tiles, curbstones, pipes and similar products that require gentle treatment.

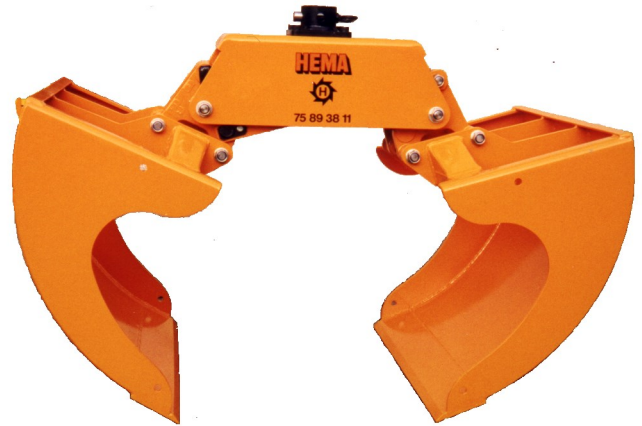

**HEMA Combi Grapple
CG90-700**



**50-90 Combi Grapple
with side plates**

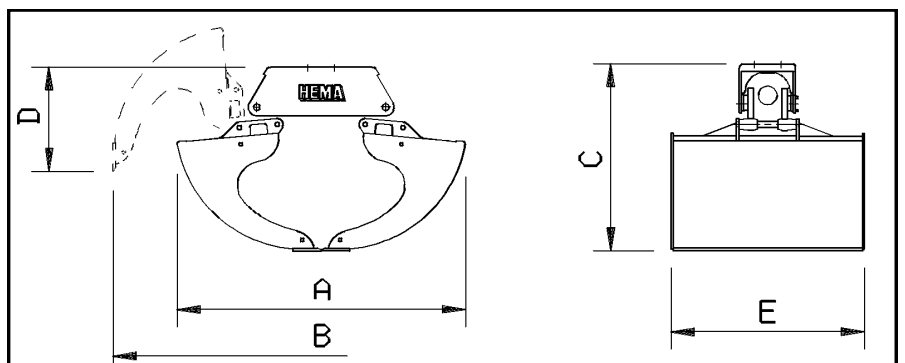

Product nr.	TYPE	Bar	Contents	A mm	B mm	C mm	D mm	E mm	Weight kg
3015 5120	CG90-350	200	350 L	1350	2100	930	540	545	355
3015 5125	CG90-500	200	500 L	1520	2220	975	550	795	430
3015 5130	CG90-700	200	700 L	1520	2220	975	550	1045	490